



PURAN BROTHERS

Disposal Inc.

Keeping It Clean Is What We Do Best

SAND & LOAM MINING
SUMMARY OF PROJECT PROPOSAL



PROJECT SUMMARY

PROJECT PROPONENT: PURAN BROTHERS DISPOSAL INC.

<i>PROJECT NAME:</i>	MINING (EXTRACTION) OF SAND & LOAM	
<i>PROJECT AREA</i>	Right Bank of the Essequibo River in an area popularly known as Ampa Bay which consist of approximately 500 acres'	
<i>ESTIMATED CAPITAL INVESTMENT:</i>	\$300,000,000 GYD	
<i>PROJECT EQUIPMENT:</i>	<ul style="list-style-type: none"> ▪ 1 Tug & Barge ▪ 3 Sand Trucks ▪ Pumps and Hoses 	<ul style="list-style-type: none"> ▪ Excavators ▪ Bulldozers ▪ Generators
<i>SAFETY EQUIPMENT:</i>	<ul style="list-style-type: none"> ▪ SAFETY BOOTS ▪ SAFETY GLOVES ▪ SAFETY RESPIRATORS ▪ SAFETY OVERALLS ▪ SAFETY GLASSES ▪ SAFETY HARNESS ▪ EARPLUGS 	<ul style="list-style-type: none"> ▪ TRAFFIC CONES ▪ UNIVERSAL SPILL KIT ▪ FIRE EXTINGUISHERS ▪ FIRST AID KIT ▪ FACE MASKS ▪ HAND SANITIZER ▪ SPILLAGE BUCKET
<i>PROJECT STAFFING:</i>	APPROXIMATELY THIRTY (30) STAFF MEMBERS	
<i>PROJECT ACTIVITIES:</i>	<ul style="list-style-type: none"> ➤ MINING OF APPROXIMATELY 30,000 CYD OF SAND, 10,000 CYD OF LOAM ON A MONTHLY BASIS. ➤ MATERIALS WILL BE TRANSPORT FROM MINIG SITE TO PARIKA OUTFALL USING A 1,200 CYD CAPACITY BARGE. ➤ MATERIAL WILL OFFLOAD AND THEN TRANSPORT TO PROJECT SITE AND EXCESS WILL BE STORED AT THE CRANE COMPOUND 	
<i>Regions of Operation</i>	Region 3 – Region 4	
<i>Project Client</i>	Government of Guyana, Central Housing and Planning Authority, Tier 1 Contractors in the Oil and Gas Sector, Private Sector and Private Individual	
<i>Expected Project Life</i>	Based on estimated reserves - 45-50 years	

PROJECT DESCRIPTION AND ACTIVITIES

This project entails the mining (extraction) of sand and loam from a Tract of State Land measuring approximately 500 acres that is located on the right bank of the Essequibo River as defined in the attached document under **Appendix I** and in the diagram below.

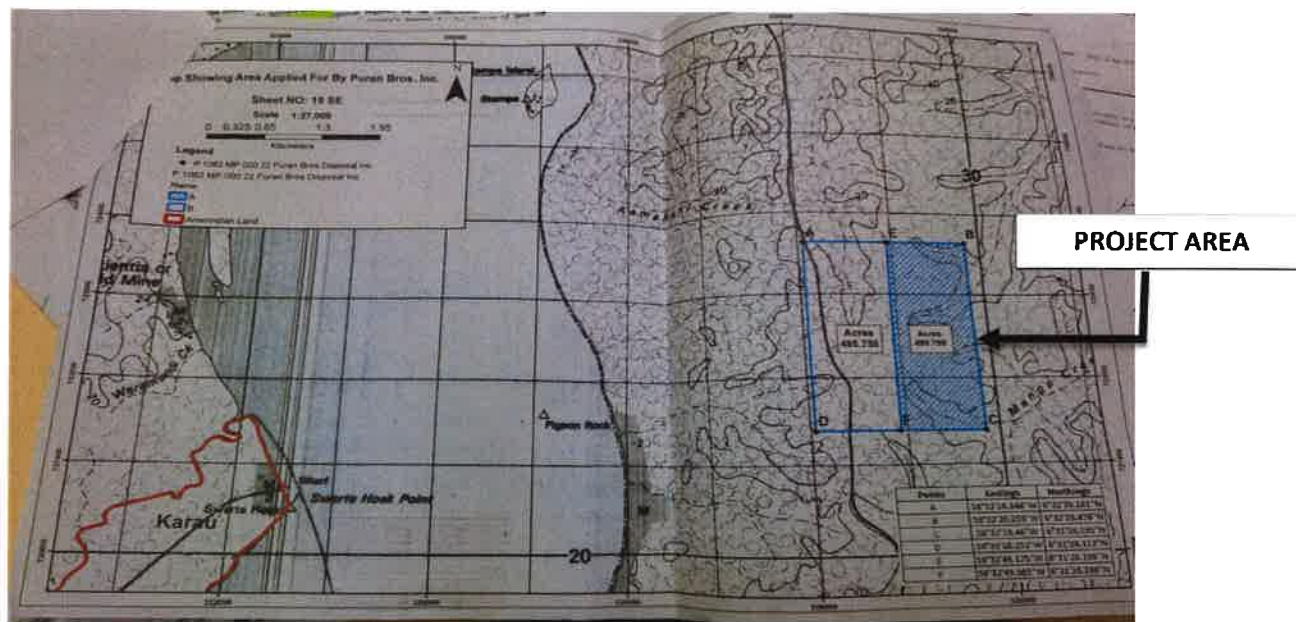

The activities associated with the mining of the sand and loam are outlined as follow:'

1. Conduct Cadastral Surveying to establish the following:
 - a. Perimeter boundaries of the plot of land.
 - b. Road alignment in keeping with the site plan
 - c. Area for Workers Living Quarters & Operations Office,
 - d. Area for Mechanical Workshop and parking of Machinery & Equipment
 - e. Establish Mining Pits for Sand and Loam
 - f. Establish area a decomposing area to store trees and other shrubs from site during land clearing exercise
 - g. Establish waste dump for storing overburden
2. Establish Temporary Camping Site with all amenities for Employee Comfort, Safety and Security.
3. Deploy the required machinery and equipment to site as listed below:
 - ✓ 1 Loader,
 - ✓ 2 Excavators,
 - ✓ 2 Sand Trucks
 - ✓ 1 Generator

4. Clearing and grubbing areas based on development schedule including internal roads and main hauling road to water front.
5. Develop Facilities to moor pontoons and to facilitating the loading of same with sand and loam.
6. Build Housing and Operations facilities
7. Commence Mining.

The timeline for the implementation of this project is outlined in the diagram below.

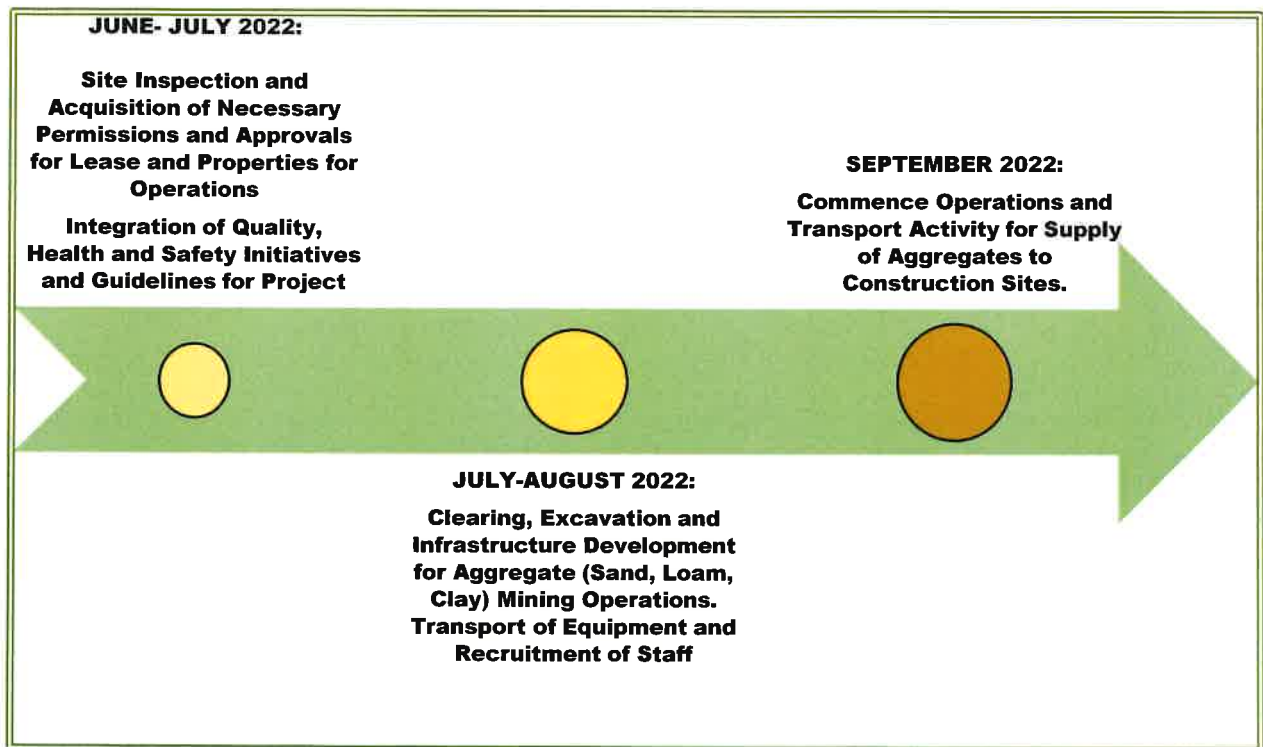

Submitted by

Lakenauth Puran
Chief Executive Officer

PURAN BROS. DISPOSAL INC.
Reg. Office 7 Bella Dam,
Pouderoyen, W.B.D
Phone: 264-2489/ 1279